

KEY

- PROPOSED DISABLED PARKING BAY - NO TIME LIMIT
- REVOCATION OF EXISTING WAITING, LOADING AND PARKING RESTRICTIONS (NOT VISIBLE IF UNDER PROPOSALS)
- EXISTING WAITING, LOADING AND PARKING RESTRICTIONS (WITH OR WITHOUT SYMBOLS)

Notes

Rev.	Description	Drwn	Sig.	Date	Chkd	Sig.	Date	Appr	Sig.	Date
A	SHEET NUMBER AND TITLE AMENDED	SDC	SDC	13.9.05	TPC	TPC	13.9.05	TPC	TPC	04.06
B	ADDED RESTRICTIONS TO HANWORTH ROAD	AJM	AJM	01.02.07	TPC	TPC	02.07	TPC	TPC	02.07
C	LINE TYPES AMENDED AND SYMBOLS ADDED	SDC	SDC	24.01.08	TPC	TPC	24.01.08	TPC	TPC	24.01.08
D	RESTRICTIONS AMENDED	CAH	CAH	10.09	SDC	SDC	10.09	TPC	TPC	10.09
E	RESTRICTIONS AMENDED	CAH	CAH	07.11	JAR	JAR	07.11	TPC	TPC	07.11
F	RESTRICTIONS AMENDED	CAH	CAH	09.16	JAR	JAR	09.16	RH	RH	09.16

Based upon the Ordnance Survey mapping with the permission of the Controller of Her Majesty's Stationery Office. © Crown copyright. Unauthorised reproduction infringes Crown copyright and may lead to prosecution or civil proceedings. Surrey County Council, LA 076872, 1996.

Drawn by: JR, Sig. JR, Date 02.05

Checked by originator: SDC, Sig. SDC, Date 03.05

Approved by: TPC, Sig. TPC, Date 03.05

Project: Borough of Spelthorne Sunbury

Drawing: Implemented Traffic Orders

SURREY COUNTY COUNCIL
Sustainable Development

Project No. 3282/SPEL
Contract Sheet No. 0138
Drawing No. 0138
Rev. F
Classification: PROPOSAL

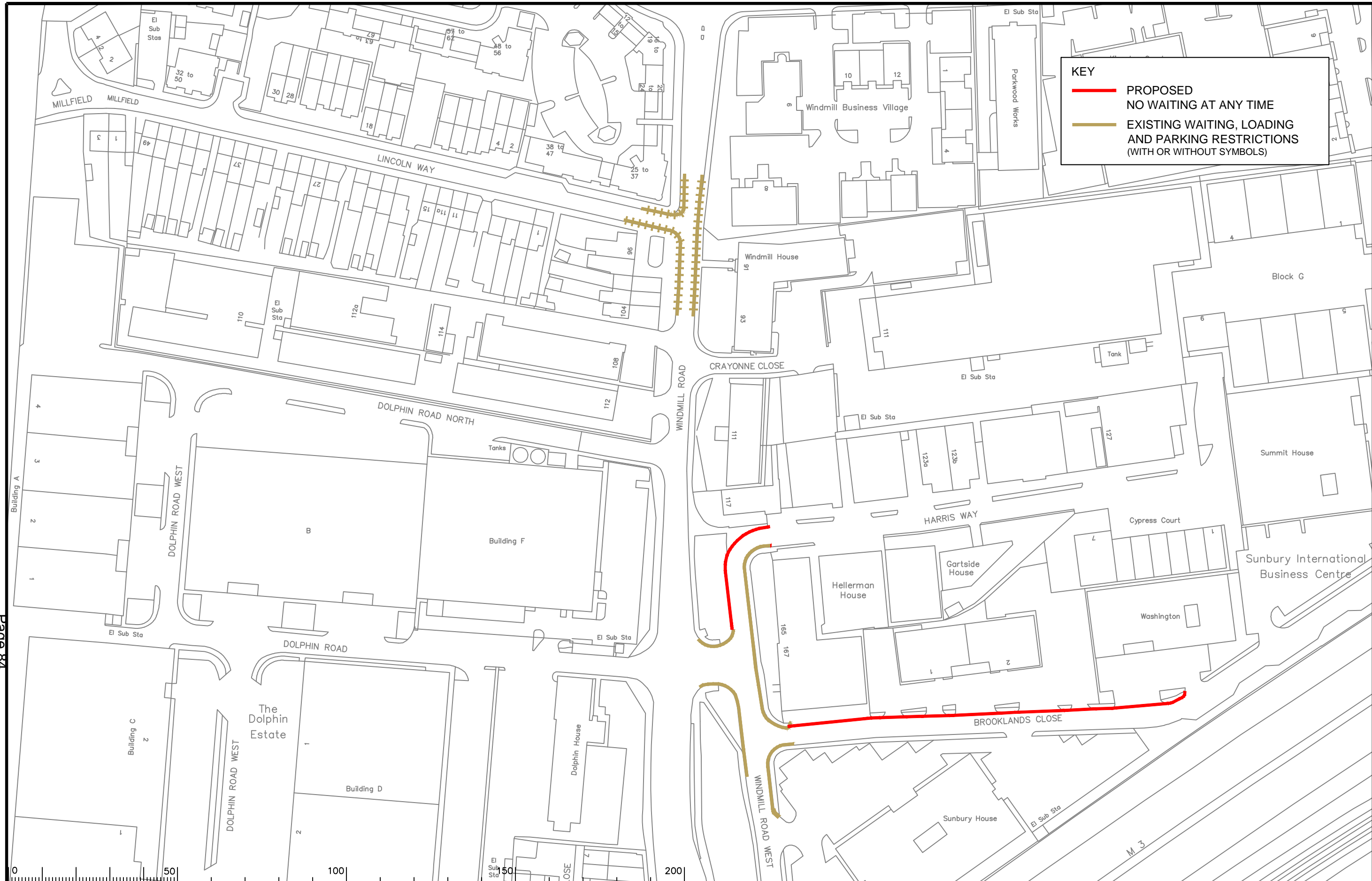

KEY

- PROPOSED NO WAITING AT ANY TIME
- EXISTING WAITING, LOADING AND PARKING RESTRICTIONS (WITH OR WITHOUT SYMBOLS)

Notes

0	50	100	150	200
---	----	-----	-----	-----

Rev.	Description	Drwn	Sig.	Date	Chkd	Sig.	Date	Appr	Sig.	Date
A	SHEET NUMBER AND TITLE AMENDED	SDC	SDC	13.9.05	TPC	TPC	13.9.05	TPC	TPC	04.08
B	LINE TYPES AMENDED AND SYMBOLS ADDED	SDC	SDC	24.01.08	TPC	TPC	24.01.08	TPC	TPC	24.01.08
C	RESTRICTIONS AND MAPPING AMENDED	CAH	CAH	10.09	SDC	SDC	10.09	TPC	TPC	10.09
D	RESTRICTIONS AMENDED	CAH	CAH	09.16	JAR	JAR	09.16	RH	RH	09.16

Based upon the Ordnance Survey mapping with the permission of the Controller of Her Majesty's Stationery Office. © Crown copyright. Unauthorised reproduction infringes Crown copyright and may lead to prosecution or civil proceedings.
Surrey County Council, LA 076872, 1996.

Drawn by: JR, Sig. JR, Date 02.05

Checked by originator: SDC, Sig. SDC, Date 03.05

Approved by: TPC, Sig. TPC, Date 03.05

Project: Borough of Spelthorne Sunbury

Drawing: Implemented Traffic Orders

Project No. 3282/SP/EL

Contract Sheet No. 0147

Rev. D

Classification: PROPOSAL

SHEET OF

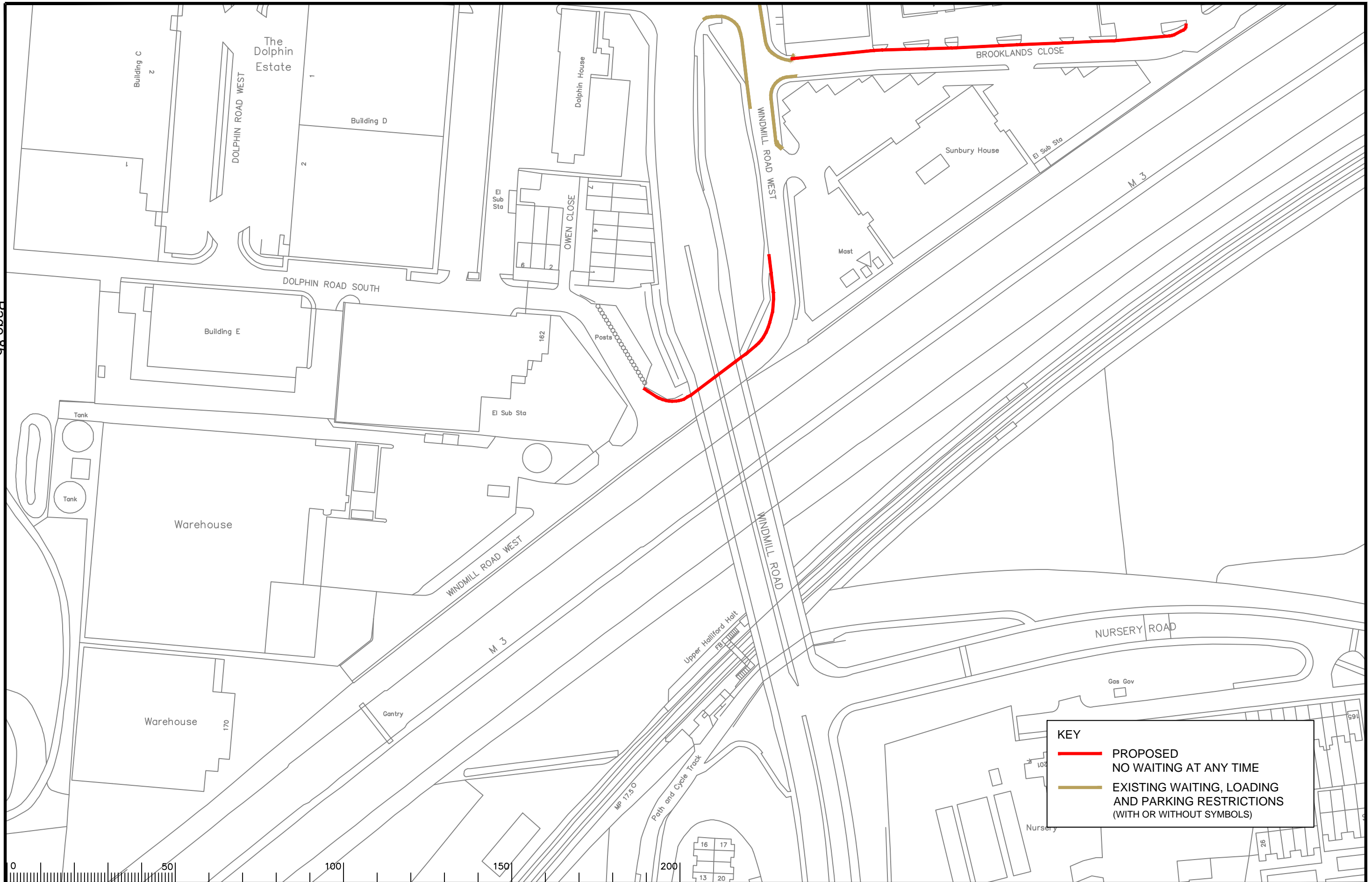

KEY

- PROPOSED NO WAITING AT ANY TIME
- EXISTING WAITING, LOADING AND PARKING RESTRICTIONS (WITH OR WITHOUT SYMBOLS)

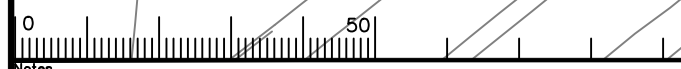

Notes

Rev.	Description	Drwn	Sig.	Date	Chkd	Sig.	Date	Appr	Sig.	Date

Rev.	Description	Drwn	Sig.	Date	Chkd	Sig.	Date	Appr	Sig.	Date

North Point

Based upon the Ordnance Survey mapping with the permission of the Controller of Her Majesty's Stationery Office. © Crown copyright. Unauthorised reproduction infringes Crown copyright and may lead to prosecution or civil proceedings. Surrey County Council, LA 076872, 1996.

Drawn by	CAH	Sig.	CAH	Date	09.16
Checked by	JAR	Sig.	JAR	Date	09.16
Approved by	RH	Sig.	RH	Date	09.16

Project

Borough of Spelthorne
Sunbury

Implemented Traffic Orders

SHEET OF

SURREY COUNTY COUNCIL
Sustainable Development
Head of Transportation
84, Lion Works
100000 City of Guilds Way, Peterborough

Project No.	3282/SPEL
Contract Sheet No.	01122
Rev.	-
Classification	PROPOSAL

This page is intentionally left blank